



**ALL WEATHER
INSULATED PANELS**

INNOVATIVE.
ADAPTABLE.
ENERGY EFFICIENT.

fiRe

Product Data Sheet

1-Hour Rated Wall Panels (Patent Pending)

fiRe 1-hour fire rated exterior wall and interior partition panels are factory assembled from a unique combination of tried and true cladding components resulting in a building composite that delivers superior performance in all categories compared with mineral wool core sandwich panels. fiRe 1-hour walls are designed to match all standard AWIP facing profiles and finishes so you won't have to settle for compromised aesthetics. With an R Value of 32, fiRe panels will meet today's restrictive energy requirements without having to weigh over 8 pounds per square foot and be 9" thick.

FEATURES AND BENEFITS

- Double the R Value per inch of other hourly rated sandwich panels.
- Factory assembled composite for one step installation.
- Structurally superior to mineral wool sandwich.
- Extremely resistant to deflection, breakage and moisture penetration.
- Available in all standard colors and profiles as AWIP standard wall products.
- Available in the same standard 40" width as AWIP standard wall products.*
- Hidden fastening at joints.
- Designed for interior partitions or exterior wall applications.

PRODUCT PARAMETERS

Panel Thickness:	4.5"
Insulating Values (R): **	32

Panel Width: 40"

Panel Length: 8' to 40' maximum

Standard Weight: 5.5 psf

Insulation Material: CFC-free foamed-in-place polyisocyanurate foam 2.1 to 2.5 pcf density.

Joint Configuration: Double offset tongue and groove with concealed fastener.

Profile Availability: All standard wall profiles (DM, HE, ST, FL).

Metal facings: 26ga galvanized steel (22ga, 24ga available).

Coatings: PVDF & SMP (other coatings available).

Accessories: Fasteners, concealed fastener clips, sealants, brake formed flashings.

**DM40-F, FL40-F, ST40-F, HE40-F, HE40A-F*

TESTED & APPROVED

All Weather Insulated Panels' products have been extensively tested under a variety of North American standards:

CAN/ULC S101: Fire Endurance

ASTM E119: 1 Hour Wall

ASTM C518/C1363: Thermal Transmission

ASTM E283: Air Infiltration

ASTM E331: Water Penetration

ASTM E72: Structural Strength

ASTM E84: Flame Spread

AAMA 501.1: Air/Water Infiltration

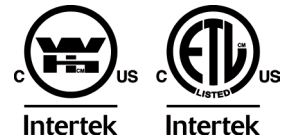

***R-Value tested in accordance with ASTM C518/C1363 at 40°F mean temperature, adjusted for a windspeed of 15 mph.*

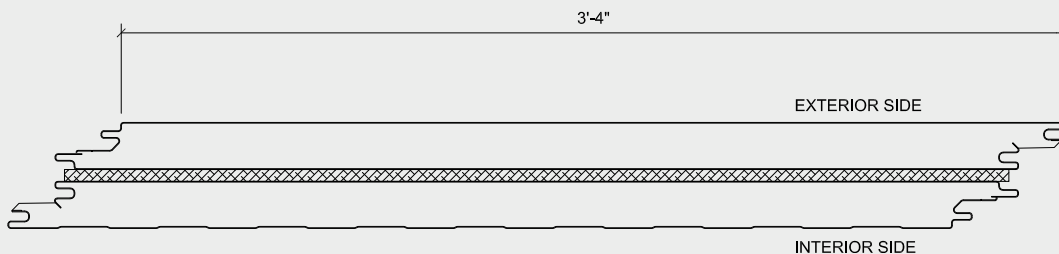

U.S.A

929 Aldridge Rd. Vacaville, CA 95688
15000 Panatella Pkwy Little Rock, AR 72206
1-888-970-AWIP (2947)
awipanel.com